

Andair Ltd  
Unit 1, Dunsbury Business Park,  
Fulflod Road,  
Havant, Hampshire  
PO9 5AX, England

Tel +44(0) 2392 473 945  
Fax +44(0) 2392 473 946  
e-mail - info@andair.co.uk  
web - www.andair.co.uk

**Andair**  
precision aircraft components

## PRODUCT - Duplex Valve FS20-20-D2

Duplex Fuel Selectors are valves that have two separate compartments so that two independent fuel lines can be switched simultaneously. This makes them ideal for fuel injected or diesel engines where there needs to be a return line. The great aspect of these valves is that the fuel can be returned to the same tank from which it was drawn, thus preventing dumping fuel overboard.

The FS20-20-D2 Duplex fuel selector is a 3/8" feed and return valve, between two fuel tanks (LEFT - RIGHT).

The Valve lever incorporates a safety feature where the red button has to be raised to switch the fuel to the OFF position. Inside the valve is a highly polished ball, packed with PTFE seal glands. This ensures a smooth and leak free operation.

The valve is available with alternative fittings (see sheet SPF20) and an extension (see sheet EX1).



Image shows FS20-20-D2-6F

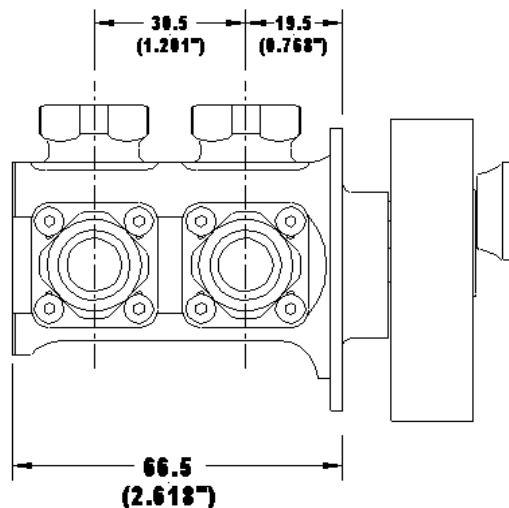

Side View

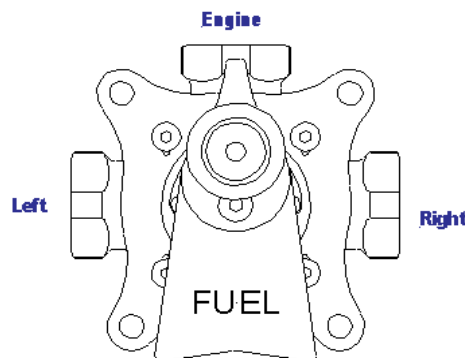

Front View

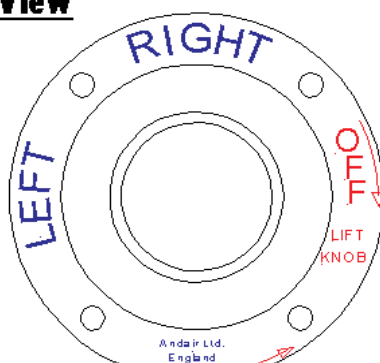

Facia Plate

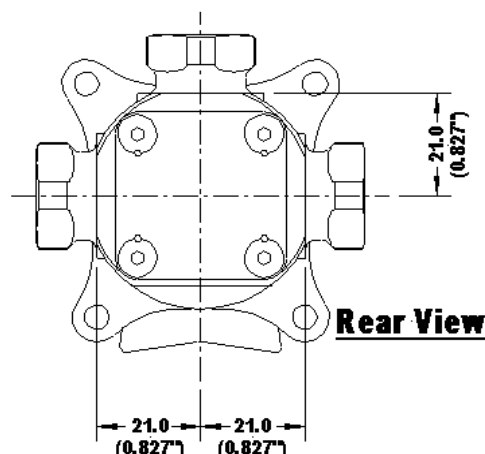

Rear View

## SPECIFICATION

Weight - 353g (ex fittings).

Fittings - 6 x SP100.

Finish - All aluminium in contact with fuel, chromic anodised.

Made from :

Body - Aluminium Alloy (L168)

Spindle - Brass (Cz121)

Ball seals - PTFE

'O' rings - Viton(R) 75

Satisfactory for all fuel types.