

Andair Ltd
Unit 1, Dunsbury Business Park,
Fulford Road,
Havant, Hampshire
PO9 5AX, England

Tel +44(0) 239 247 3945
Fax +44(0) 239 247 3946
Email - info@andair.co.uk
Website - www.andair.co.uk



PRODUCT - Throttle Quadrant

The Andair Throttle Quadrant has primarily been designed for the RV range of aircraft. Over several years of flying the RV6, we have designed some unique features that give this quadrant it's great looks and a solid feel. The handle of the throttle lever is angled to give the best ergonomic position and grip for the right hand, which will fall naturally to take up this position. On top of the handle is the optional flap control switch. This is a key safety feature which allows the pilot to deploy the flaps without taking his or her hand off of the throttle. This give much greater control on approaches and go arounds. The flap control switch consists of two colour coded push to make buttons, one for flaps down and one for flaps up.

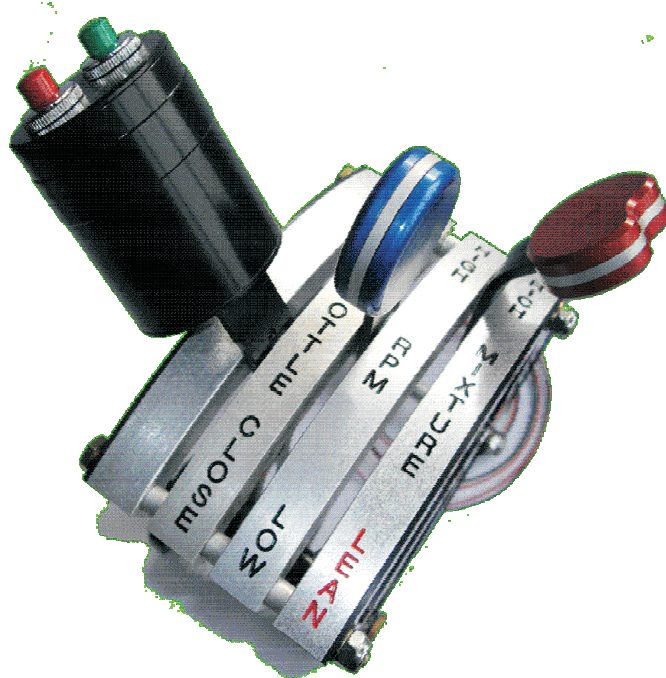

Each lever is guided by Teflon® pads at the top to give a feel that is both smooth and accurate. Along the base is a friction nut that can be used to lock all three levers, although this can be overridden with a gentle pressure.

The friction nut can easily be positioned on the right side of the base and the mixture lever has a detent arrangement to positively hold it in the 'cutoff' position.

The right hand version is shown, but a left hand version is also available.

The Andair Throttle Quadrant is available in several models, please see our website to configure the Quadrant to your requirements.

Andair Ltd
Unit 1, Dunsbury Business Park,
Fulford Road,
Havant, Hampshire
PO9 5AX, England

Tel +44(0) 239 247 3945
Fax +44(0) 239 247 3946
Email - info@andair.co.uk
Website - www.andair.co.uk



PRODUCT - Throttle Quadrant

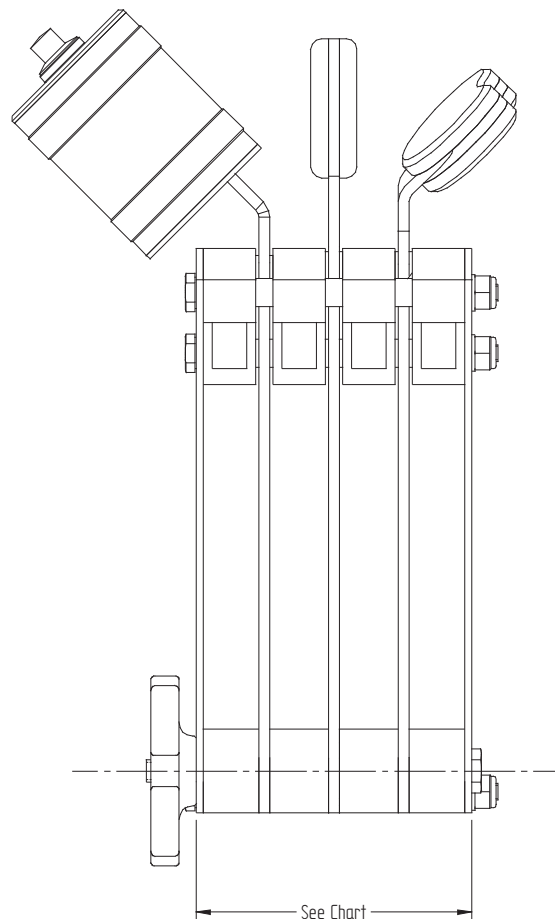
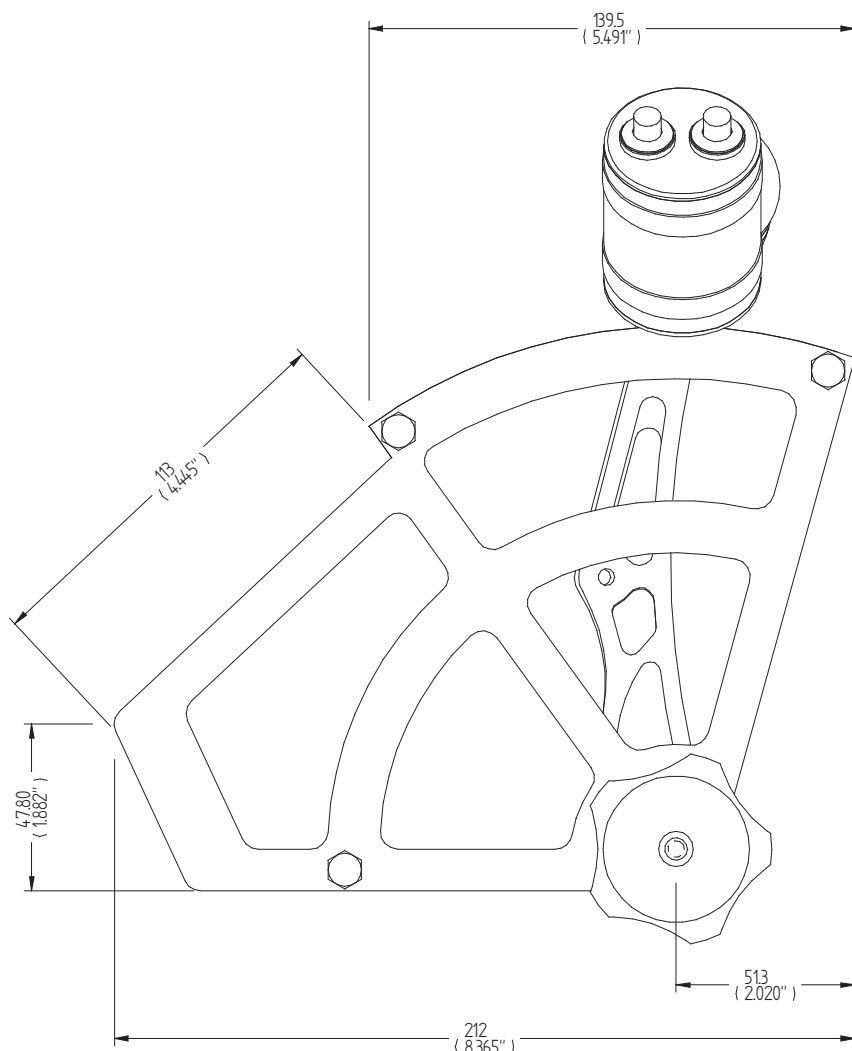

| <u>Model</u> | <u>Prop Lever</u> | <u>Mixture Lever</u> | <u>Flap Switches</u> | <u>Width</u> |
|--------------|-------------------|----------------------|----------------------|----------------|
| TQX1 | Yes | Yes | Yes | 79.0mm (3.03") |
| TQX2 | Yes | Yes | No | 79.0mm (3.03") |
| TQX3 | No | Yes | Yes | 59.0mm (2.32") |
| TQX4 | No | Yes | No | 59.0mm (2.32") |
| TQX5 | No | No | Yes | 39.0mm (1.54") |
| TQX6 | No | No | No | 39.0mm (1.54") |
| TQX7 | Yes | No | Yes | 59.0mm (2.32") |
| TQX8 | Yes | No | No | 59.0mm (2.32") |

Right hand version shown, for a left hand version add a 'L' to the end of the model number e.g. TQX1L